

**Rescheduled for May 14, 2013 Planning Commission
Due to inaccurate public notice map of areas affected.**

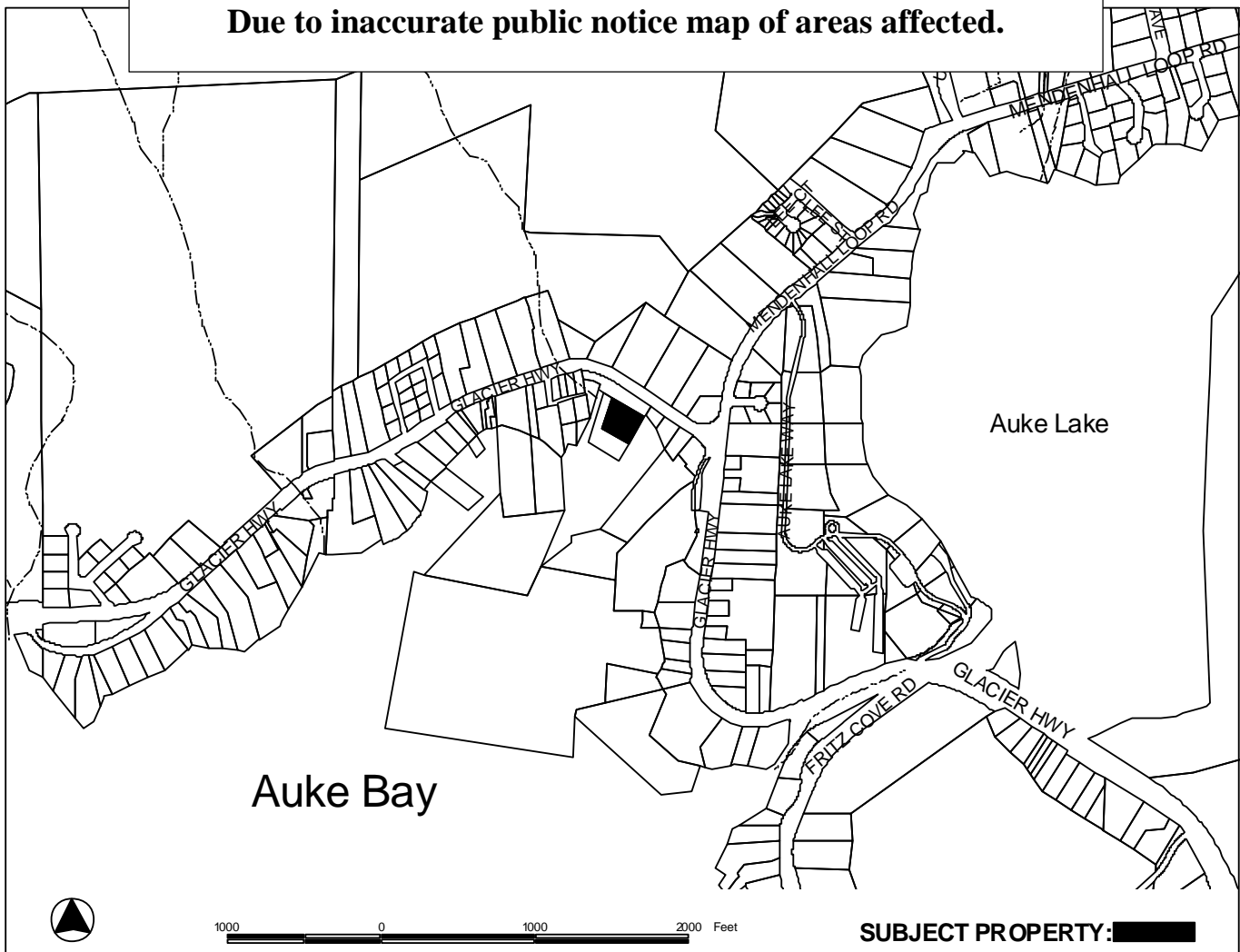

PROPOSAL: A Conditional Use Permit and City Project Review for construction of a new two-lane boat launch ramp and associated parking at Statter Harbor

FILE NO: USE2013 0005	APPLICANT: CBJ Docks & Harbors
TO: Adjacent Property Owners	Property PCN: 4-B28-0-101-007-0
HEARING DATE: Apr 23, 2013	Owner: CITY AND BOROUGH OF JUNEAU & LANDS AND RESOURCES
HEARING TIME: 7:00 PM	Size: 1.01 acres
PLACE: ASSEMBLY CHAMBERS Municipal Building 155 South Seward St Juneau, Alaska 99801	Zoned: WATERFRONT COMMERCIAL
	Site Address: GLACIER HWY
	Accessed via: GLACIER HWY

PROPERTY OWNERS PLEASE NOTE:

You are invited to attend this Public Hearing and present oral testimony. The Planning Commission will also consider written testimony. You are encouraged to submit written material to the Community Development Department no later than 8:30 A.M. on the Wednesday preceding the Public Hearing. Materials received by this deadline are included in the information packet given to the Planning Commission a few days before the Public Hearing. Written material received after the deadline will be provided to the Planning Commission at the Public Hearing.

If you have questions, please contact Greg Chaney at greg_chaney@ci.juneau.ak.us or at 586-0715.

Planning Commission Agendas, Staff Reports and Meeting Results can be viewed at www.juneau.org/plancomm.